

REGULATORY COMMITTEE	DATE 14 TH NOVEMBER, 2007
PLANNING APPLICATION N/07/07008	LOCATION PURTON: PARKGATE FARM
Reproduced from the Ordnance Survey Map with the permission of The Controller of H.M. Stationery Office Crown Copyright reserved. 100023455	WILTSHIRE COUNTY COUNCIL Director of Environmental Services County Hall Trowbridge Wiltshire BA14 8JD
SCALE: 1:10,000	

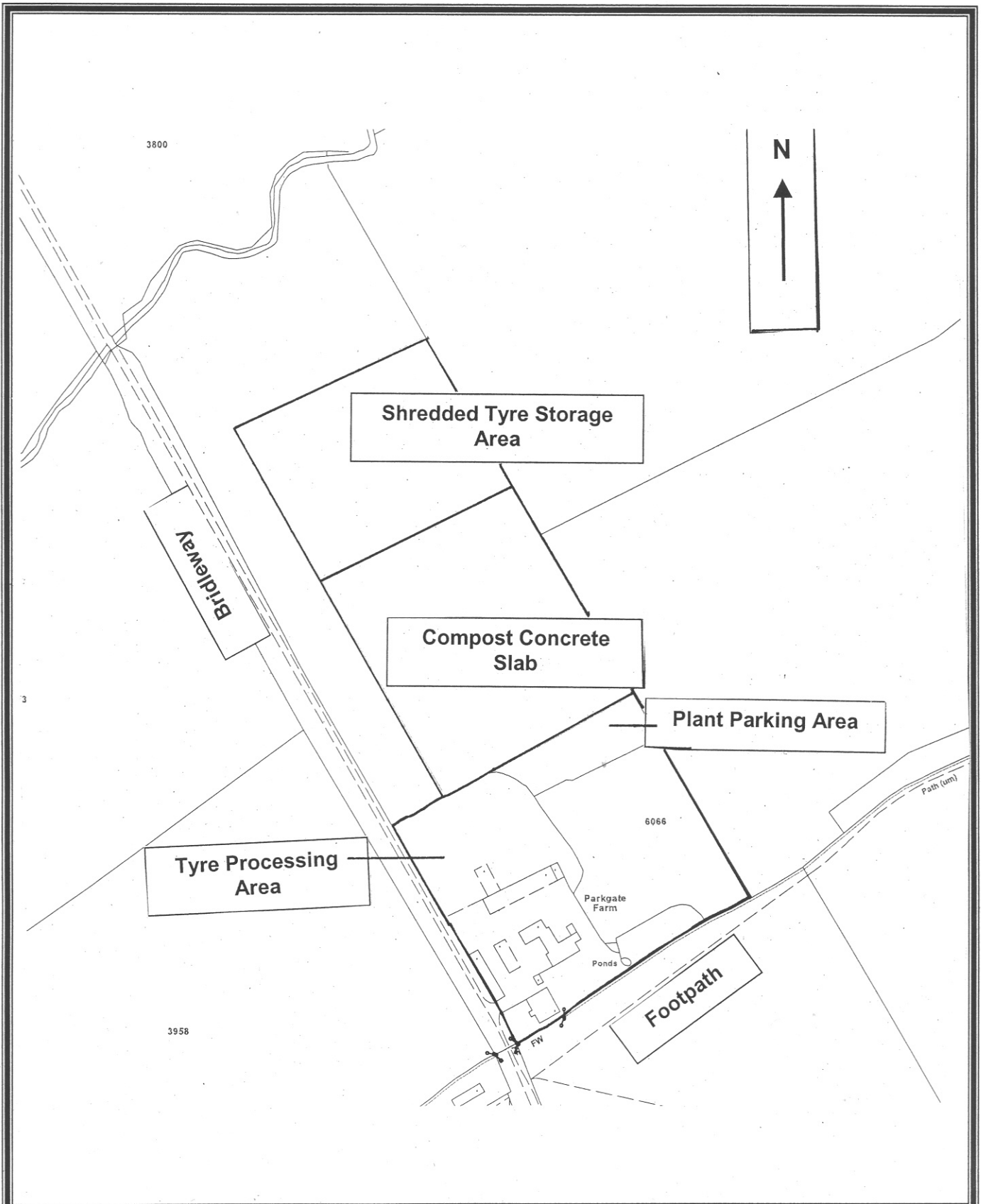

REGULATORY COMMITTEE	DATE 14 th NOVEMBER, 2007
PLANNING APPLICATION N/07/07008	SITE PURTON: PARKGATE FARM
Reproduced from the Ordnance Survey Map with the permission of The Controller of H.M. Stationery Office Crown Copyright reserved. 100023455	WILTSHIRE COUNTY COUNCIL Director of Environmental Services County Hall Trowbridge Wiltshire BA14 8JD
SCALE: 1:2,000	