

Appendix 1

- A. **THE COUNTY OF WILTSHIRE (VARIOUS ROADS, SALISBURY) (PROHIBITION AND RESTRICTION OF WAITING LOADING AND UNLOADING) ORDER 2000 (AMENDMENT NO.4) ORDER 2001**
- B. **THE COUNTY OF WILTSHIRE (SALISBURY - ZONE G - HARNHAM) (WAITING RESTRICTIONS AND RESIDENTS' PARKING PLACES) ORDER 2001**

NOTICE IS HEREBY GIVEN that Wiltshire County Council proposes to make the above-mentioned Orders, the effect of which will be to create a Residents Parking Zone in Harnham by amending The County of Wiltshire (Various Roads, Salisbury) (Prohibition and Restriction of Waiting Loading and Unloading) Order 2000 and by Prohibiting Waiting At All Times and providing Waiting Limited to 2 hours No Return Within 4 Hours (Except Permit Holders) 9.00 am – 5.00 pm Monday to Saturday on parts of the following roads in Salisbury: Ayleswade Road, De Vaux Place, Harnham Road, Swan Close, and St. Nicholas' Road. Notices are displayed in the roads affected and full details may be seen in the Salisbury Journal on 3 May 2001.

Copies of the proposed Orders, plans and Statement of the County Council's reasons for proposing to make the Orders may be inspected at the offices of the Director of Environmental Services, County Hall, Trowbridge and at the offices of Salisbury District Council, The Council House, Bourne Hill, Salisbury during normal office hours.

Objections to the proposals together with the grounds on which they are made should be sent in writing to reach the undersigned by not later than 30 May 2001 quoting reference JM/TRO/SALIS/ZONEG.

RICHARD LANDER
Director of Environmental Services

County Hall
Trowbridge BA14 8JD.

3 May 2001

This map is based upon Ordnance Survey material with permission of Ordnance Survey on behalf of the Controller of Her Majesty's Stationery Office Crown copyright. Unauthorised reproduction infringes Crown copyright and may lead to prosecution or civil proceedings. Wiltshire County Council LA076910 2001

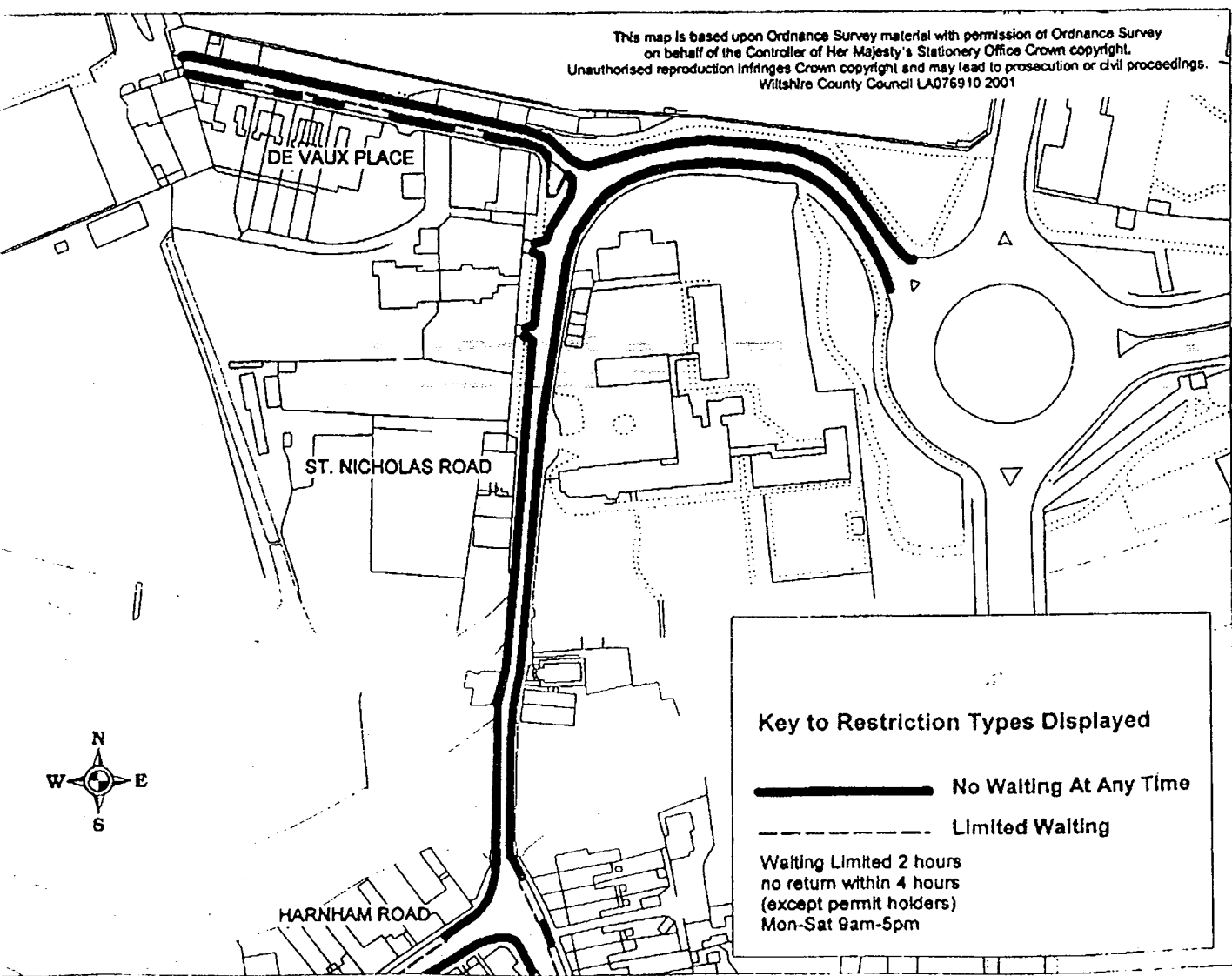

WILTSHIRE COUNTY COUNCIL

ROAD TRAFFIC REGULATION ACT 1984
ROAD TRAFFIC ACT 1991

- A. THE COUNTY OF WILTSHIRE (VARIOUS ROADS, SALISBURY)
(PROHIBITION AND RESTRICTION OF WAITING LOADING AND UNLOADING) ORDER 2000
(AMENDMENT NO.4) ORDER 2001
- B. THE COUNTY OF WILTSHIRE (SALISBURY – ZONE G - HARNHAM) (WAITING RESTRICTIONS
AND RESIDENTS' PARKING PLACES) ORDER 2001

NOTICE IS HEREBY GIVEN that Wiltshire County Council proposes to make the above-mentioned Orders, the effect of which will be to create a Residents Parking Zone in Harnham by amending The County of Wiltshire (Various Roads, Salisbury) (Prohibition and Restriction of Waiting Loading and Unloading) Order 2000 and by Prohibiting Waiting At All Times and providing Waiting Limited to 2 hours No Return Within 4 Hours (Except Permit Holders) 9.00 am – 5.00 pm Monday to Saturday on parts of the following roads in Salisbury: Ayleswade Road, De Vaux Place, Harnham Road, Swan Close, and St. Nicholas' Road. Notices are displayed in the roads affected and full details may be seen in the Salisbury Journal on 3 May 2001.

Copies of the proposed Orders, plans and Statement of the County Council's reasons for proposing to make the Orders may be inspected at the offices of the Director of Environmental Services, County Hall, Trowbridge and at the offices of Salisbury District Council, The Council House, Bourne Hill, Salisbury during normal office hours.

Objections to the proposals together with the grounds on which they are made should be sent in writing to reach the undersigned by not later than 30 May 2001 quoting reference JM/TRO/SALIS/ZONEG.

RICHARD LANDER
Director of Environmental Services

County Hall
Trowbridge BA14 8JD.

3 May 2001

