

27 JUN 2012

**Application for a premises licence to be granted
under the Licensing Act 2003**

PLEASE READ THE FOLLOWING INSTRUCTIONS FIRST

PASSED TO _____	REPLIED _____
COPIES TO _____	

Before completing this form please read the guidance notes at the end of the form.
If you are completing this form by hand please write legibly in block capitals. In all cases ensure that your answers are inside the boxes and written in black ink. Use additional sheets if necessary.
You may wish to keep a copy of the completed form for your records.

I/We Wiltshire Council

(Insert name(s) of applicant)

apply for a premises licence under section 17 of the Licensing Act 2003 for the premises described in Part 1 below (the premises) and I/we are making this application to you as the relevant licensing authority in accordance with section 12 of the Licensing Act 2003

Part 1 – Premises Details

Postal address of premises or, if none, ordnance survey map reference or description Wilton Development Centre for Young People The Hollows			
Post town	Wilton	Post code	SP2 0JE
Telephone number at premises (if any)		07919 547706	
Non-domestic rateable value of premises		£	

Part 2 - Applicant Details

Please state whether you are applying for a premises licence as

Please tick yes

- | | | |
|---|--------------------------|-----------------------------|
| a) an individual or individuals * | <input type="checkbox"/> | please complete section (A) |
| b) a person other than an individual * | | |
| i. as a limited company | <input type="checkbox"/> | please complete section (B) |
| ii. as a partnership | <input type="checkbox"/> | please complete section (B) |
| iii. as an unincorporated association or | <input type="checkbox"/> | please complete section (B) |
| iv. other (for example a statutory corporation) | <input type="checkbox"/> | please complete section (B) |
| c) a recognised club | <input type="checkbox"/> | please complete section (B) |
| d) a charity | <input type="checkbox"/> | please complete section (B) |

- e) the proprietor of an educational establishment please complete section (B)
- f) a health service body please complete section (B)
- g) a person who is registered under Part 2 of the Care Standards Act 2000 (c14) in respect of an independent hospital in Wales please complete section (B)
- ga) a person who is registered under Chapter 2 of Part 1 of the Health and Social Care Act 2008 (within the meaning of that Part) in an independent hospital in England please complete section (B)
- h) the chief officer of police of a police force in England and Wales please complete section (B)

* If you are applying as a person described in (a) or (b) please confirm:

Please tick yes

- I am carrying on or proposing to carry on a business which involves the use of the premises for licensable activities; or
- I am making the application pursuant to a
 - statutory function or
 - a function discharged by virtue of Her Majesty's prerogative

(A) INDIVIDUAL APPLICANTS (fill in as applicable)

Mr <input type="checkbox"/>	Mrs <input type="checkbox"/>	Miss <input type="checkbox"/>	Ms <input type="checkbox"/>	Other Title (for example, Rev)	
Surname			First names		
I am 18 years old or over				<input type="checkbox"/> Please tick yes	
Current postal address if different from premises address					
Post Town				Postcode	
Daytime contact telephone number					
E-mail address (optional)					

SECOND INDIVIDUAL APPLICANT (if applicable)

Mr <input type="checkbox"/>	Mrs <input type="checkbox"/>	Miss <input type="checkbox"/>	Ms <input type="checkbox"/>	Other Title (for example, Rev)	
Surname			First names		

I am 18 years old or over		<input type="checkbox"/> Please tick yes	
Current postal address if different from premises address			
Post Town		Postcode	
Daytime contact telephone number			
E-mail address (optional)			

(B) OTHER APPLICANTS

Please provide name and registered address of applicant in full. Where appropriate please give any registered number. In the case of a partnership or other joint venture (other than a body corporate), please give the name and address of each party concerned.

Name Kevin Sweeney – Area Manager, Integrated Youth Service
Address Operational HQ Estcourt Crescent Devizes SN10 1LR
Registered number (where applicable)
Description of applicant (for example, partnership, company, unincorporated association etc.) Area Manager, Integrated Youth Service
Telephone number (if any) 01380 735786
E-mail address (optional)

Part 3 Operating Schedule

When do you want the premises licence to start?

Day		Month		Year	
0	1	0	6	2	0
1	2	1	2		

If you wish the licence to be valid only for a limited period, when do you want it to end?

Day		Month		Year	

Please give a general description of the premises (please read guidance note1)
Purpose built single storey building.

If 5,000 or more people are expected to attend the premises at any one time, please state the number expected to attend.

What licensable activities do you intend to carry on from the premises?

(Please see sections 1 and 14 of the Licensing Act 2003 and Schedules 1 and 2 to the Licensing Act 2003)

Provision of regulated entertainment

Please tick yes

- | | |
|---|-------------------------------------|
| a) plays (if ticking yes, fill in box A) | <input type="checkbox"/> |
| b) films (if ticking yes, fill in box B) | <input checked="" type="checkbox"/> |
| c) indoor sporting events (if ticking yes, fill in box C) | <input type="checkbox"/> |
| d) boxing or wrestling entertainment (if ticking yes, fill in box D) | <input type="checkbox"/> |
| e) live music (if ticking yes, fill in box E) | <input checked="" type="checkbox"/> |
| f) recorded music (if ticking yes, fill in box F) | <input checked="" type="checkbox"/> |
| g) performances of dance (if ticking yes, fill in box G) | <input checked="" type="checkbox"/> |
| h) anything of a similar description to that falling within (e), (f) or (g) (if ticking yes, fill in box H) | <input checked="" type="checkbox"/> |

Provision of entertainment facilities:

- | | |
|---|-------------------------------------|
| i) making music (if ticking yes, fill in box I) | <input checked="" type="checkbox"/> |
| j) dancing (if ticking yes, fill in box J) | <input checked="" type="checkbox"/> |
| k) entertainment of a similar description to that falling within (i) or (j) (if ticking yes, fill in box K) | <input checked="" type="checkbox"/> |

Provision of late night refreshment (if ticking yes, fill in box L)

Supply of alcohol (if ticking yes, fill in box M)

In all cases complete boxes N, O and P

A

Plays Standard days and timings (please read guidance note 6)			<u>Will the performance of a play take place indoors or outdoors or both – please tick</u> (please read guidance note 2)	Indoors	<input type="checkbox"/>			
				Outdoors	<input type="checkbox"/>			
				Both	<input type="checkbox"/>			
Day	Start	Finish	<u>Please give further details here</u> (please read guidance note 3)					
Mon								
Tue								
Wed						<u>State any seasonal variations for performing plays</u> (please read guidance note 4)		
Thur								
Fri						<u>Non standard timings. Where you intend to use the premises for the performance of plays at different times to those listed in the column on the left, please list</u> (please read guidance note 5)		
Sat								
Sun								

B

Films Standard days and timings (please read guidance note 6)			Will the exhibition of films take place indoors or outdoors or both – please tick (please read guidance note 2)	Indoors	<input checked="" type="checkbox"/>
Day	Start	Finish		Outdoors	<input type="checkbox"/>
Mon	18:30	21:30	Please give further details here (please read guidance note 3)	Both	<input type="checkbox"/>
Tue	18:30	21:30			
Wed	18:30	21:30	State any seasonal variations for the exhibition of films (please read guidance note 4)		
Thur	18:30	21:30			
Fri	18:30	21:30	Non standard timings. Where you intend to use the premises for the exhibition of films at different times to those listed in the column on the left, please list (please read guidance note 5) <i>On five Saturdays throughout the year 18:30 to 21:30</i>		
Sat					
Sun					

Amended inline with email 27/06/2012 - DM

C

Indoor sporting events Standard days and timings (please read guidance note 6)			<u>Please give further details</u> (please read guidance note 3)
Day	Start	Finish	
Mon			
Tue			<u>State any seasonal variations for indoor sporting events</u> (please read guidance note 4)
Wed			
Thur			<u>Non standard timings. Where you intend to use the premises for indoor sporting events at different times to those listed in the column on the left, please list</u> (please read guidance note 5)
Fri			
Sat			
Sun			

D

Boxing or wrestling entertainments Standard days and timings (please read guidance note 6)			<u>Will the boxing or wrestling entertainment take place indoors or outdoors or both – please tick</u> (please read guidance note 2)	Indoors	<input type="checkbox"/>
Day	Start	Finish		Outdoors	<input type="checkbox"/>
				Both	<input type="checkbox"/>
Mon			<u>Please give further details here</u> (please read guidance note 3)		
Tue					
Wed			<u>State any seasonal variations for boxing or wrestling entertainment</u> (please read guidance note 4)		
Thur					
Fri			<u>Non standard timings. Where you intend to use the premises for boxing or wrestling entertainment at different times to those listed in the column on the left, please list</u> (please read guidance note 5)		
Sat					
Sun					

E

Live music Standard days and timings (please read guidance note 6)			Will the performance of live music take place indoors or outdoors or both – please tick (please read guidance note 2)	Indoors	<input checked="" type="checkbox"/>
Day	Start	Finish		Outdoors	<input type="checkbox"/>
Mon	18:30	21:30	Please give further details here (please read guidance note 3)	Both	<input type="checkbox"/>
Tue	18:30	21:30			
Wed	18:30	21:30	State any seasonal variations for the performance of live music (please read guidance note 4)		
Thur	18:30	21:30			
Fri	18:30	21:30	Non standard timings. Where you intend to use the premises for the performance of live music at different times to those listed in the column on the left, please list (please read guidance note 5) <i>on five Saturdays throughout the year 18:30 to 21:30</i>		
Sat					
Sun					

Amended online with email 27/06/2012 - DM

F

Recorded music Standard days and timings (please read guidance note 6)			Will the playing of recorded music take place indoors or outdoors or both – please tick (please read guidance note 2)	Indoors	<input checked="" type="checkbox"/>
				Outdoors	<input type="checkbox"/>
				Both	<input type="checkbox"/>
Day	Start	Finish	Please give further details here (please read guidance note 3)		
Mon	18:30	21:30			
Tue	18:30	21:30			
Wed	18:30	21:30	State any seasonal variations for the playing of recorded music (please read guidance note 4)		
Thur	18:30	21:30			
Fri	18:30	21:30			
Sat			Non standard timings. Where you intend to use the premises for the playing of recorded music at different times to those listed in the column on the left, please list (please read guidance note 5)		
Sun					
			on five Saturdays throughout the year 18:30 - 21:30		

Amended inline with email 27/06/2012 - Rm

G

Performances of dance Standard days and timings (please read guidance note 6)			Will the performance of dance take place indoors or outdoors or both – please tick (please read guidance note 2)	Indoors	<input checked="" type="checkbox"/>
Day	Start	Finish		Outdoors	<input type="checkbox"/>
Mon	18:30	21:30	Please give further details here (please read guidance note 3)	Both	<input type="checkbox"/>
Tue	18:30	21:30			
Wed	18:30	21:30	State any seasonal variations for the performance of dance (please read guidance note 4)		
Thur	18:30	21:30			
Fri	18:30	21:30	Non standard timings. Where you intend to use the premises for the performance of dance at different times to those listed in the column on the left, please list (please read guidance note 5) <i>on five Saturdays throughout the year 18:30 to 21:30</i>		
Sat					
Sun					

Amended online with email 27/06/2012

H

Anything of a similar description to that falling within (e), (f) or (g) Standard days and timings (please read guidance note 6)			<u>Please give a description of the type of entertainment you will be providing</u>		
Day	Start	Finish	<u>Will this entertainment take place indoors or outdoors or both – please tick</u> (please read guidance note 2)	Indoors	<input checked="" type="checkbox"/>
Mon	18:30	21:30		Outdoors	<input type="checkbox"/>
				Both	<input type="checkbox"/>
Tue	18:30	21:30	<u>Please give further details here</u> (please read guidance note 3)		
Wed	18:30	21:30			
Thur	18:30	21:30	<u>State any seasonal variations for entertainment of a similar description to that falling within (e), (f) or (g)</u> (please read guidance note 4)		
Fri	18:30	21:30			
Sat			<u>Non standard timings. Where you intend to use the premises for the entertainment of a similar description to that falling within (e), (f) or (g) at different times to those listed in the column on the left, please list</u> (please read guidance note 5)		
Sun			<i>On five Saturdays throughout the year 18:30 to 21:30</i>		

Amended inline with email 27/06/2012 - DM

I

Provision of facilities for making music Standard days and timings (please read guidance note 6)			<u>Please give a description of the facilities for making music you will be providing</u>	
			<u>Will the facilities for making music be indoors or outdoors or both – please tick</u> (please read guidance note 2)	
			Outdoors <input type="checkbox"/>	
Day	Start	Finish	<u>Both</u> <input type="checkbox"/>	
Mon	18:30	21:30	<u>Please give further details here</u> (please read guidance note 3)	
Tue	18:30	21:30		
Wed	18:30	21:30	<u>State any seasonal variations for the provision of facilities for making music</u> (please read guidance note 4)	
Thur	18:30	21:30		
Fri	18:30	21:30	<u>Non standard timings. Where you intend to use the premises for provision of facilities for making music at different times to those listed in the column on the left, please list</u> (please read guidance note 5) <i>On five Saturdays throughout the year 18.30 to 21.30</i>	
Sat				
Sun				

Amended inline with email 27/06/2012 - AM

J

Provision of facilities for dancing Standard days and timings (please read guidance note 6)			Will the facilities for dancing be indoors or outdoors or both – please tick (see guidance note 2)	Indoors	<input checked="" type="checkbox"/>
				Outdoors	<input type="checkbox"/>
				Both	<input type="checkbox"/>
			Please give a description of the facilities for dancing you will be providing		
Day	Start	Finish	Please give further details here (please read guidance note 3)		
Mon	18:30	21:30			
Tue	18:30	21:30	State any seasonal variations for providing dancing facilities (please read guidance note 4)		
Wed	18:30	21:30			
Thur	18:30	21:30	Non standard timings. Where you intend to use the premises for the provision of facilities for dancing entertainment at different times to those listed in the column on the left, please list (please read guidance note 5) <i>On five Saturdays throughout the year 18:30 to 21:30</i>		
Fri	18:30	21:30			
Sat					
Sun					

Amended online with email 27/06/2012 - DM

K

Provision of facilities for entertainment of a similar description to that falling within i or j Standard days and timings (please read guidance note 6)			<u>Please give a description of the type of entertainment facility you will be providing</u>		
Day	Start	Finish	<u>Will the entertainment facility be indoors or outdoors or both – please tick</u> (please read guidance note 2)	Indoors	<input checked="" type="checkbox"/>
Mon	18:30	21:30		Outdoors	<input type="checkbox"/>
				Both	<input type="checkbox"/>
Tue	18:30	21:30	<u>Please give further details here</u> (please read guidance note 3)		
Wed	18:30	21:30			
Thur	18:30	21:30	<u>State any seasonal variations for the provision of facilities for entertainment of a similar description to that falling within i or j</u> (please read guidance note 4)		
Fri	18:30	21:30			
Sat			<u>Non standard timings. Where you intend to use the premises for the provision of facilities for entertainment of a similar description to that falling within i or j at different times to those listed in the column on the left, please list</u> (please read guidance note 5)		
Sun			On five Saturdays throughout the year 18.30 to 21.30		

Amended inline with email 27/06/2012 - DM

L

Late night refreshment Standard days and timings (please read guidance note 6)			Will the provision of late night refreshment take place indoors or outdoors or both – please tick (please read guidance note 2)	Indoors	<input checked="" type="checkbox"/>
				Outdoors	<input type="checkbox"/>
Day	Start	Finish	Both		
Mon	18:30	21:30	Please give further details here (please read guidance note 3) N/A		
Tue	18:30	21:30			
Wed	18:30	21:30	State any seasonal variations for the provision of late night refreshment (please read guidance note 4)		
Thur	18:30	21:30			
Fri	18:30	21:30	Non standard timings. Where you intend to use the premises for the provision of late night refreshment at different times, to those listed in the column on the left, please list (please read guidance note 5)		
Sat					
Sun					

M

Supply of alcohol Standard days and timings (please read guidance note 6)			Will the supply of alcohol be for consumption (Please tick box) (please read guidance note 7)	On the premises	<input type="checkbox"/>
				Off the premises	<input type="checkbox"/>
Day	Start	Finish	Both <input type="checkbox"/>		
Mon			State any seasonal variations for the supply of alcohol (please read guidance note 4)		
Tue					
Wed					
Thur			Non standard timings. Where you intend to use the premises for the supply of alcohol at different times to those listed in the column on the left, please list (please read guidance note 5)		
Fri					
Sat					
Sun					

State the name and details of the individual whom you wish to specify on the licence as premises supervisor

Name
Address
Postcode
Personal Licence number (if known)
Issuing licensing authority (if known)

N

Please highlight any adult entertainment or services, activities, other entertainment or matters ancillary to the use of the premises that may give rise to concern in respect of children (please read guidance note 8)

O

Hours premises are open to the public Standard days and timings (please read guidance note 6)			State any seasonal variations (please read guidance note 4)
Day	Start	Finish	
Mon	18:30	21:30	Non standard timings. Where you intend the premises to be open to the public at different times from those listed in the column on the left, please list (please read guidance note 5) Permission to open 18:30 – 21:30 on five Saturdays throughout the year
Tue	18:30	21:30	
Wed	18:30	21:30	
Thur	18:30	21:30	
Fri	18:30	21:30	
Sat			
Sun			

P Describe the steps you intend to take to promote the four licensing objectives:

a) General – all four licensing objectives (b,c,d,e) (please read guidance note 9)

Events are supported by local police, which promotes all four licensing objectives. Youth work staff manage the events and there is a high ratio of staff supervising the young people.

b) The prevention of crime and disorder

Events are well supervised and supported by local police.

c) Public safety

Fire evacuation plan in place and up to date fire risk assessment completed. Emergency exits clearly marked. Maximum capacity is not exceeded and events are supported by local police.

d) The prevention of public nuisance

People encouraged to leave quietly at the end of the event and not loiter. Supervised by youth work staff and supported by local police.

e) The protection of children from harm

Events are well supervised and supported by local police.

Please tick yes

- I have made or enclosed payment of the fee NA
- I have enclosed the plan of the premises
- I have sent copies of this application and the plan to responsible authorities and others where applicable
- I have enclosed the consent form completed by the individual I wish to be premises supervisor, if applicable
- I understand that I must now advertise my application
- I understand that if I do not comply with the above requirements my application will be rejected

IT IS AN OFFENCE, LIABLE ON CONVICTION TO A FINE UP TO LEVEL 5 ON THE STANDARD SCALE, UNDER SECTION 158 OF THE LICENSING ACT 2003 TO MAKE A FALSE STATEMENT IN OR IN CONNECTION WITH THIS APPLICATION

Part 4 – Signatures (please read guidance note 10)

Signature of applicant or applicant’s solicitor or other duly authorised agent (See guidance note 11). **If signing on behalf of the applicant please state in what capacity.**

Signature	<i>Kw Gray</i>
Date	<i>24/5/12</i>
Capacity	<i>Area Manager</i>

For joint applications signature of 2nd applicant or 2nd applicant’s solicitor or other authorised agent. (please read guidance note 12). **If signing on behalf of the applicant please state in what capacity.**

Signature	
Date	
Capacity	

Contact name (where not previously given) and postal address for correspondence associated with this application (please read guidance note 13)			
Debbie Lymer Integrated Youth Service – Operational HQ Estcourt Crescent			
Post town	Devizes	Post code	SN10 1LR
Telephone number (if any)	01380 735782		
If you would prefer us to correspond with you by e-mail your e-mail address (optional) debbie.lymer@wiltshire.gov.uk			

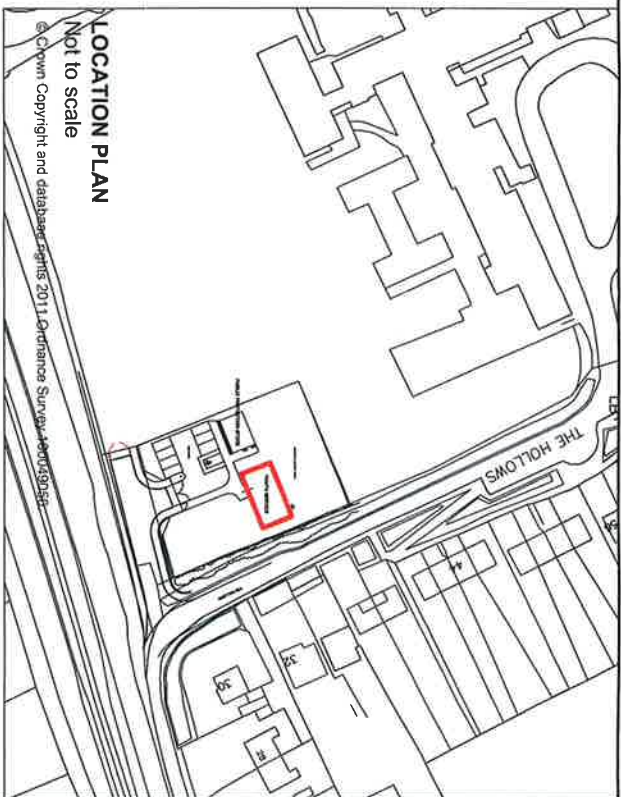

COPY

LICENSING AUTHORITY
 CERTIFIED COPY
 DATE 27 June 2012

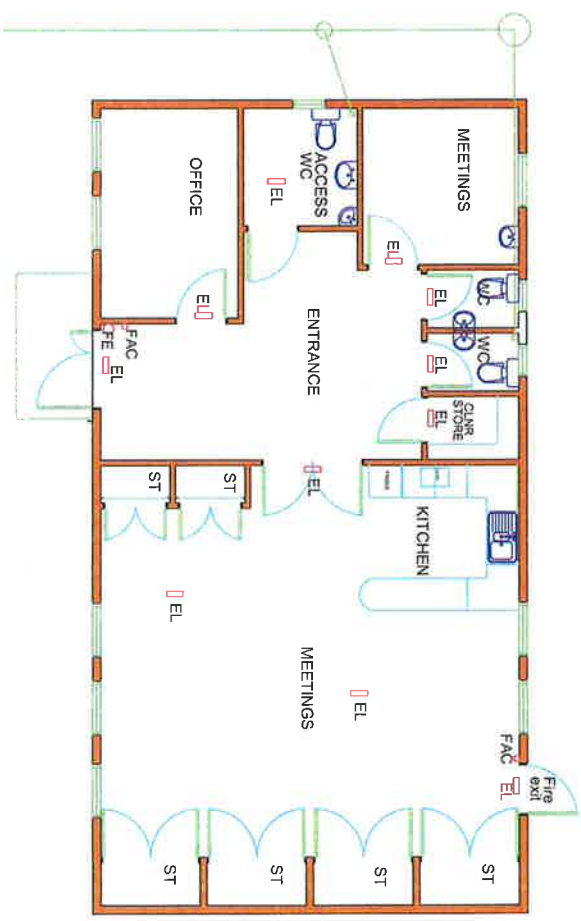

Block 01
Youth Centre Building



- KEY**
- Fire alarm call point shown thus FAC
 - Emergency lights shown thus EL
 - Fire extinguisher shown thus FE

SITE:	WILTON YOUTH CENTRE		
UPRN:	01661S1	SCALE:	1:100@A3
		DATE:	July 2011
		CAD REF:	01661S1-D1
NOTES:			