

Southampton Road - Proposed Cycle Route to Marshmead Close

Copyright © 2010 by the Ordnance Survey, made with the permission of the Controller of the Ordnance Survey under the Ordnance Survey Act 1947. Ordnance Survey is a registered trademark of the Ordnance Survey. Ordnance Survey is a registered trademark of the Ordnance Survey. Ordnance Survey is a registered trademark of the Ordnance Survey.

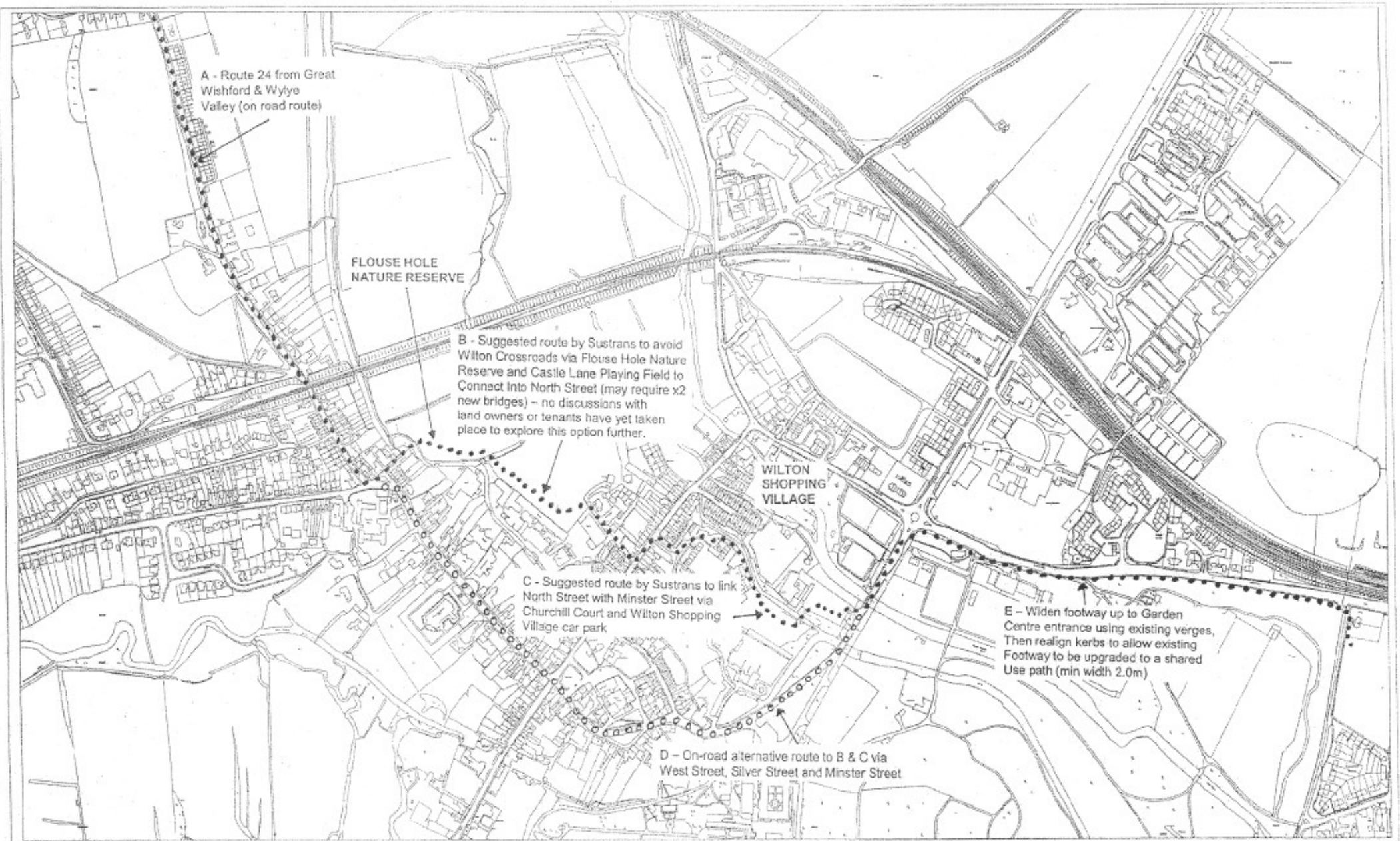

Client	Salisbury Joint Transportation Team		
Project	Sustrans Route 24		
Drawing Title	Salisbury to Alderbury Cycle Route Route Past Hughenden Manor		
Issuing Office	Salisbury	Drawn	Scale NTS
Telephone		Issue	
File Ref.	12.07.10	Drawing No.	SJSR24SA0001
		Version	A



## Sustrans Route 24 - Salisbury to Wilton Proposed Cycle Route - Plan 1 of 3

SCALE: 1:5000

DATE: 4th July 2006

DEPARTMENTS:JTT

Reproduced from Ordnance Survey material with the permission of the Ordnance Survey on behalf of the Controller of Her Majesty's Stationery Office © Crown Copyright. Unauthorised reproduction infringes Crown Copyright and may lead to prosecution or civil proceedings.  
Licence No. 100033329, Salisbury District Council 2005.

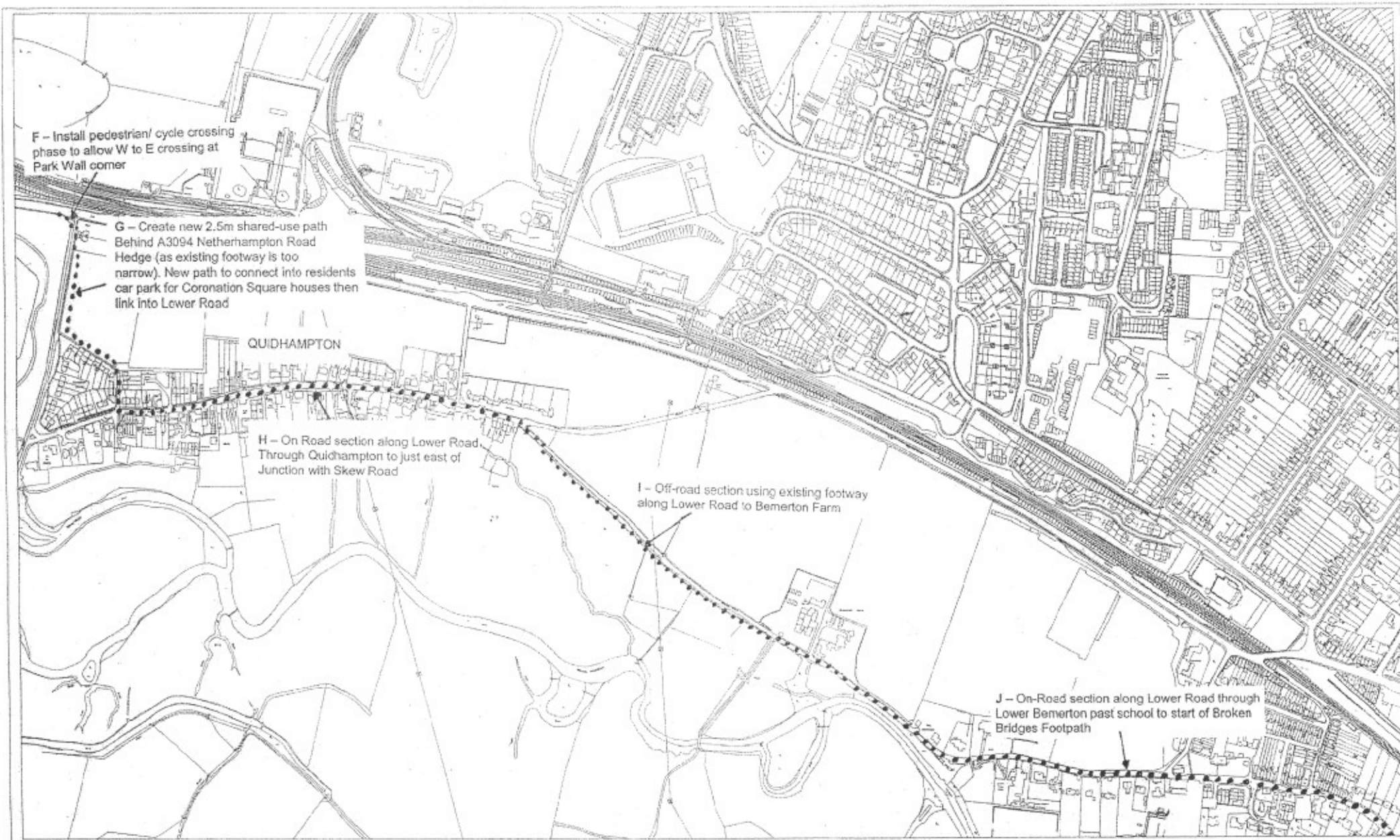

## Sustrans Route 24 - Salisbury to Wilton Proposed Cycle Route - Plan 2 of 3

SCALE: 1:5000

DATE: 4th July 2006

DEPARTMENTS: JTT

Reproduced from Ordnance Survey material with the permission of the Ordnance Survey on behalf of the Controller of Her Majesty's Stationery Office © Crown Copyright. Unauthorised reproduction infringes Crown Copyright and may lead to prosecution or civil proceedings.  
Licence No. 100033329, Salisbury District Council 2005.

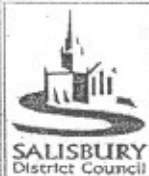
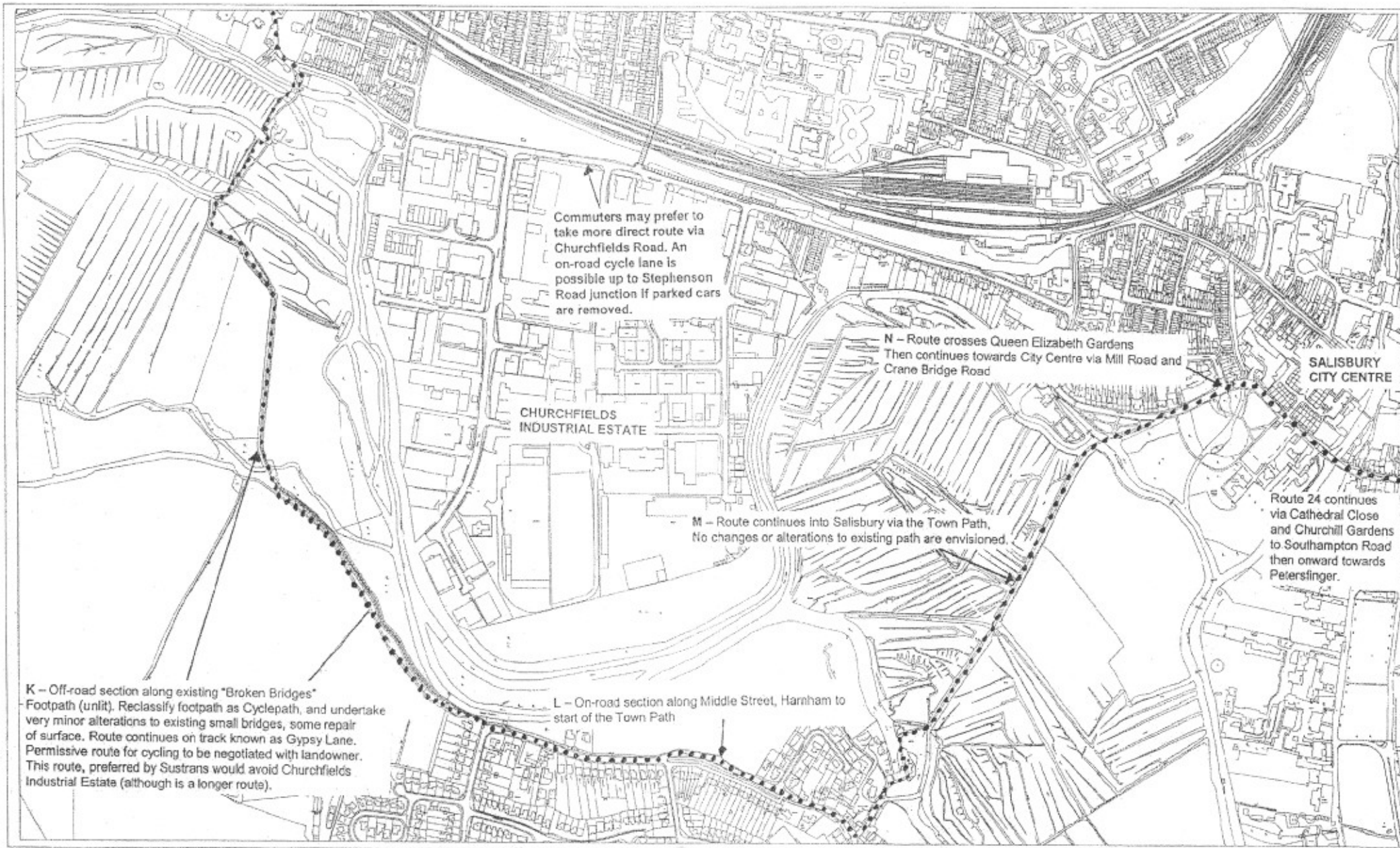

## Sustrans Route 24 - Salisbury to Wilton Proposed Cycle Route - Plan 3 of 3

SCALE: 1:5000

DATE: 4th July 2006

DEPARTMENT: JTT

Reproduced from Ordnance Survey material with the permission of the Ordnance Survey on behalf of the Controller of Her Majesty's Stationery Office © Crown Copyright. Unauthorised reproduction infringes Crown Copyright and may lead to prosecution or civil proceedings.  
Licence No. 100033329, Salisbury District Council 2005.