

REGULATORY COMMITTEE		DATE	8 <sup>th</sup> SEPTEMBER 2004
PLANNING APPLICATION	S.04.0889	LAYOUT PLAN	REDLYNCH: POUND BOTTOM LANDFILL SITE
Reproduced from the Ordnance Survey Map with the permission of The Controller of H.M. Stationery Office Crown Copyright reserved. 100023455		<b>WILTSHIRE COUNTY COUNCIL</b> Director of Environmental Services County Hall Trowbridge Wiltshire BA14 8JD	
SCALE:	1:10,000		

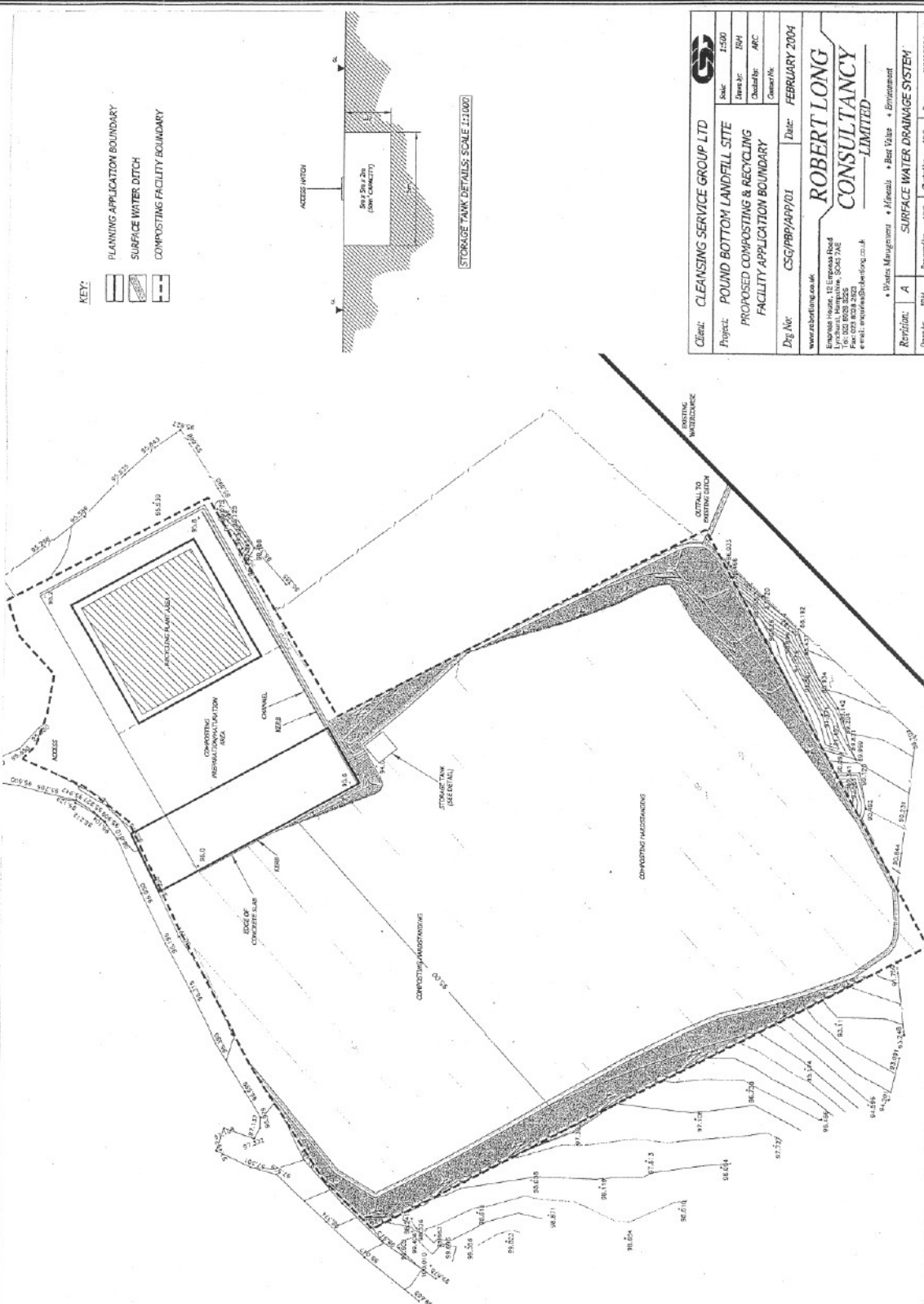

<b>Client:</b> CLEANSING SERVICE GROUP LTD	<b>Scale:</b> 1:500
<b>Project:</b> POUND BOTTOM LANDFILL SITE	<b>Date:</b> 2004
<b>PROPOSED COMPOSTING &amp; RECYCLING FACILITY APPLICATION BOUNDARY</b>	<b>Drawn by:</b> ARC
	<b>Checked by:</b> ARC
	<b>Consent No.:</b>
<b>Dwg No.:</b> CSG/PBP/APP/01	<b>Date:</b> FEBRUARY 2004
www.robertlong.co.uk	
<b>ROBERT LONG CONSULTANCY LIMITED</b>	
Enterprise House, 15 Enterprise Road Lyndhurst, Hampshire, SO43 7AE Tel: 01256 820000 Fax: 01256 820000 e-mail: enquiries@robertlong.co.uk	
<b>Revision:</b> A	<b>Request by:</b> ABC
<b>Drawn by:</b> ARC	<b>Checked by:</b> ARC
<b>Date:</b> 2004	<b>Date:</b> 2004

<b>REGULATORY COMMITTEE</b>	<b>DATE</b>	<b>8<sup>th</sup> SEPTEMBER 2004</b>
<b>PLANNING APPLICATION</b>	<b>S.04.0889</b>	<b>SITE PLAN</b>
		<b>REDLYNCH: POUND BOTTOM LANDFILL SITE</b>
Reproduced from the Ordnance Survey Map with the permission of The Controller of H.M. Stationery Office Crown Copyright reserved. 100023455		<b>WILTSHIRE COUNTY COUNCIL</b> Director of Environmental Services County Hall Trowbridge Wiltshire BA14 8JD
<b>SCALE:</b>	<b>1:500</b>	