

**Wiltshire**  
COUNTY COUNCIL

George Batten BSc (Hons) C.Eng FICE FIHT  
The Director of Environmental Services  
County Hall, Trowbridge, Wiltshire. BA14 8JD

REGULATORY COMMITTEE

DATE :	6th OCTOBER 2004
LOCATION :	CALNE - A4 CURZON STREET \ THE SQUARE INITIAL PROPOSALS
SCALE :	1 : 1000

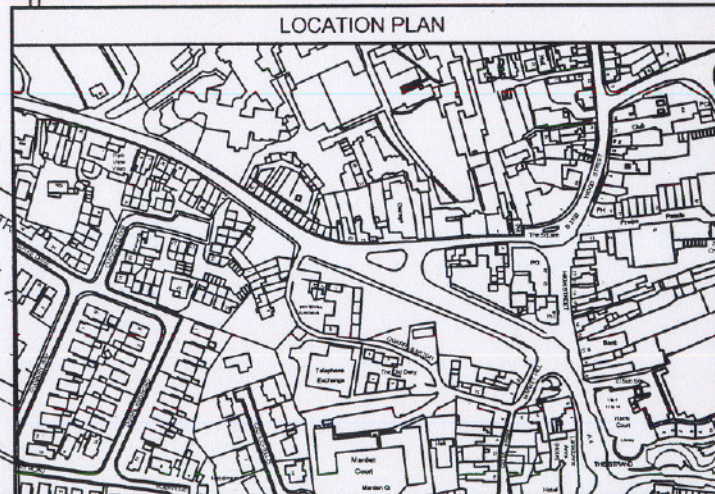
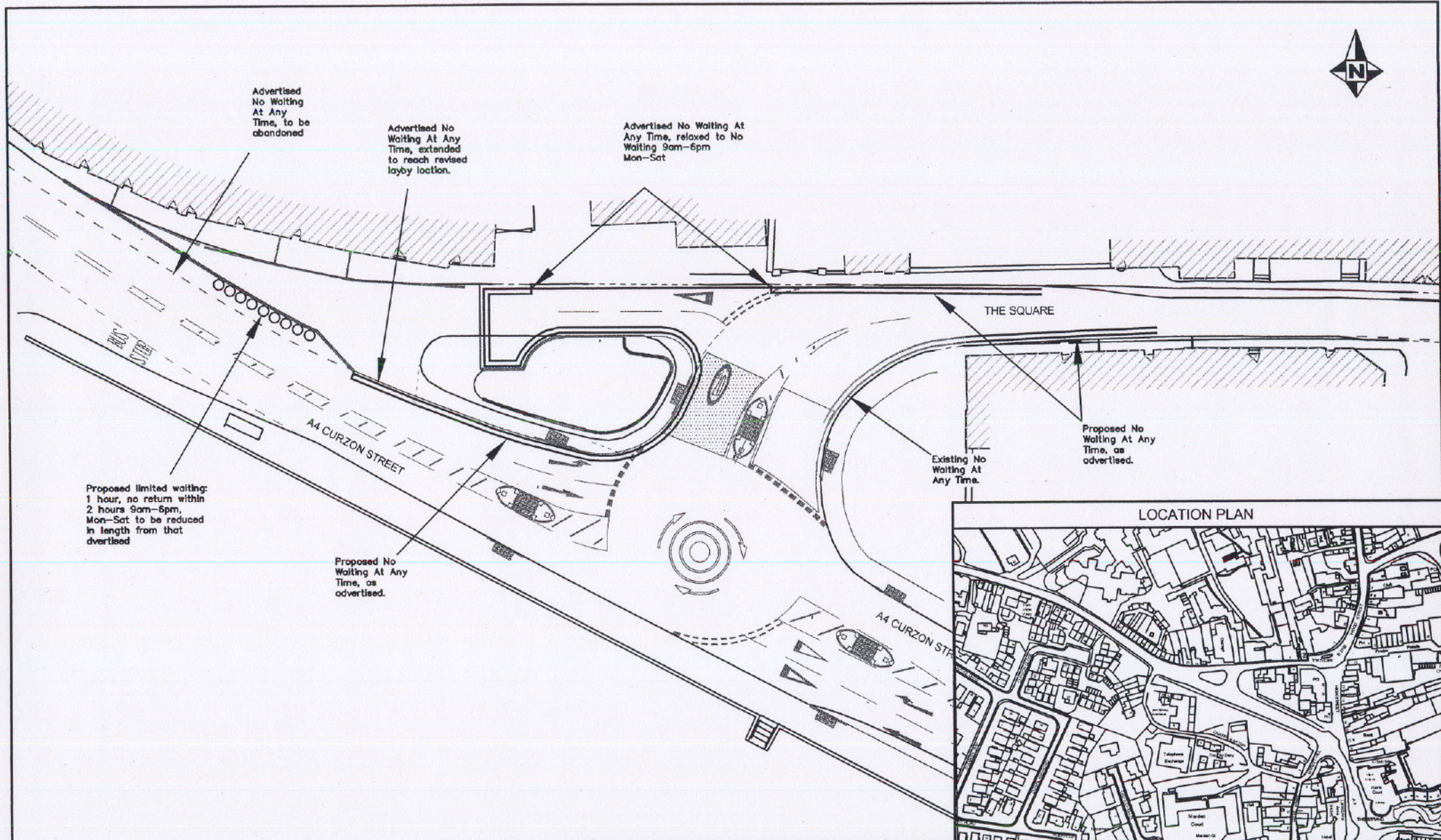

George Batten BSc (Hons) C.Eng FICE FIHT  
 The Director of Environmental Services  
 County Hall, Trowbridge, Wiltshire. BA14 8JD

REGULATORY COMMITTEE	
DATE :	6th OCTOBER 2004
LOCATION :	CALNE - A4 CURZON STREET \ THE SQUARE PROPOSED AMENDMENTS
SCALE :	1:500