

REGULATORY COMMITTEE	DATE	2 nd FEBRUARY 2005	
PLANNING APPLICATION	K.50834	LOCATION	ROUNDWAY/STERT: MONUMENT HILL WASTE RECYCLING SITE
Reproduced from the Ordnance Survey Map with the permission of The Controller of H.M. Stationery Office Crown Copyright reserved. 100023455		WILTSHIRE COUNTY COUNCIL Director of Environmental Services County Hall Trowbridge Wiltshire BA14 8JD	
SCALE:	1:10,000		

PROPOSED BANKING. MONUMENT HILL WASTE RECYCLING SITE. for WILTSHIRE WASTE RECYCLING LTD.

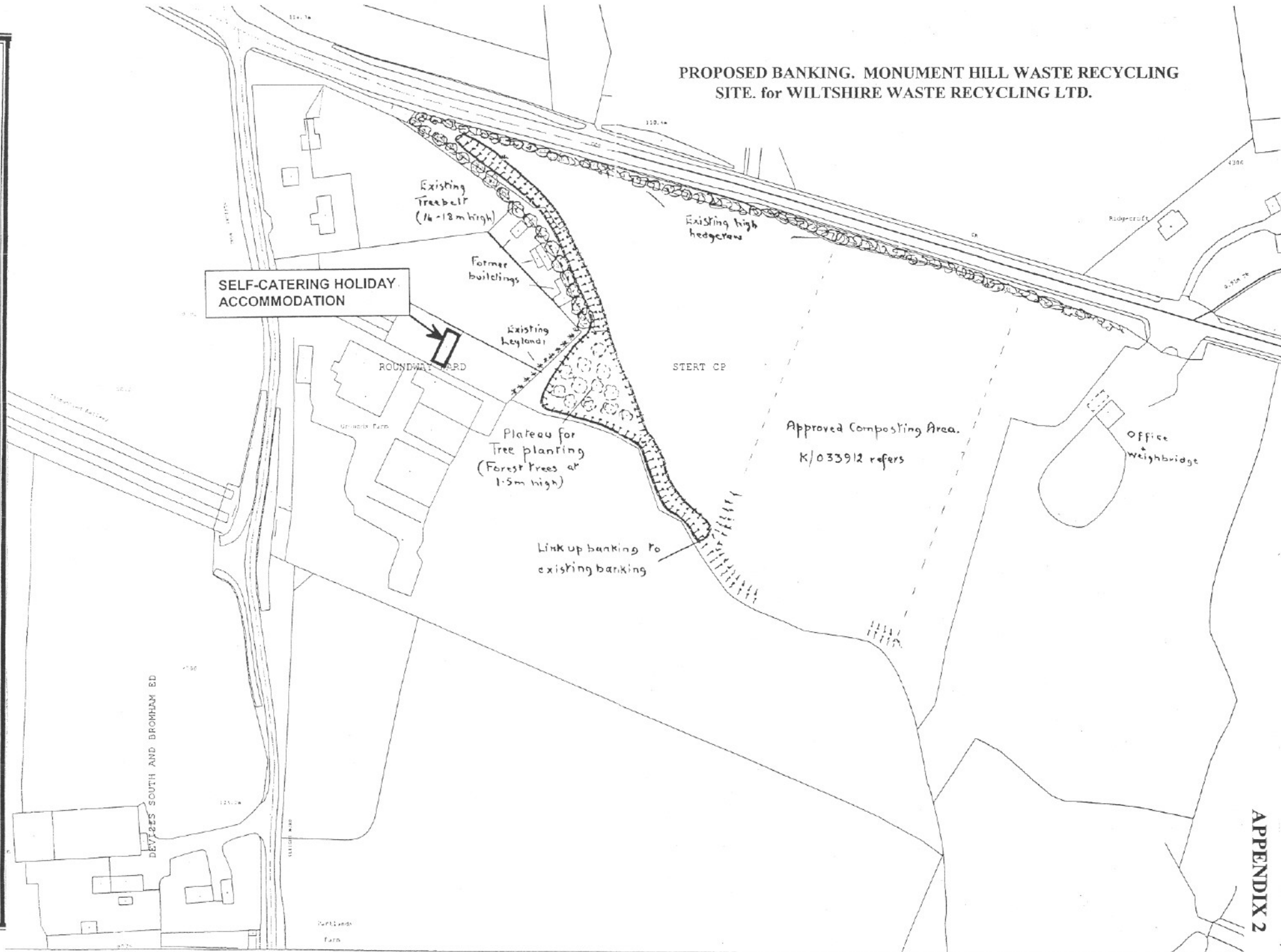

REGULATORY COMMITTEE	DATE
PLANNING APPLICATION K.50834	2 ND FEBRUARY 2005
Not to Scale	SITE ROUNDWAY/STERT: MONUMENT HILL WASTE RECYCLING SITE

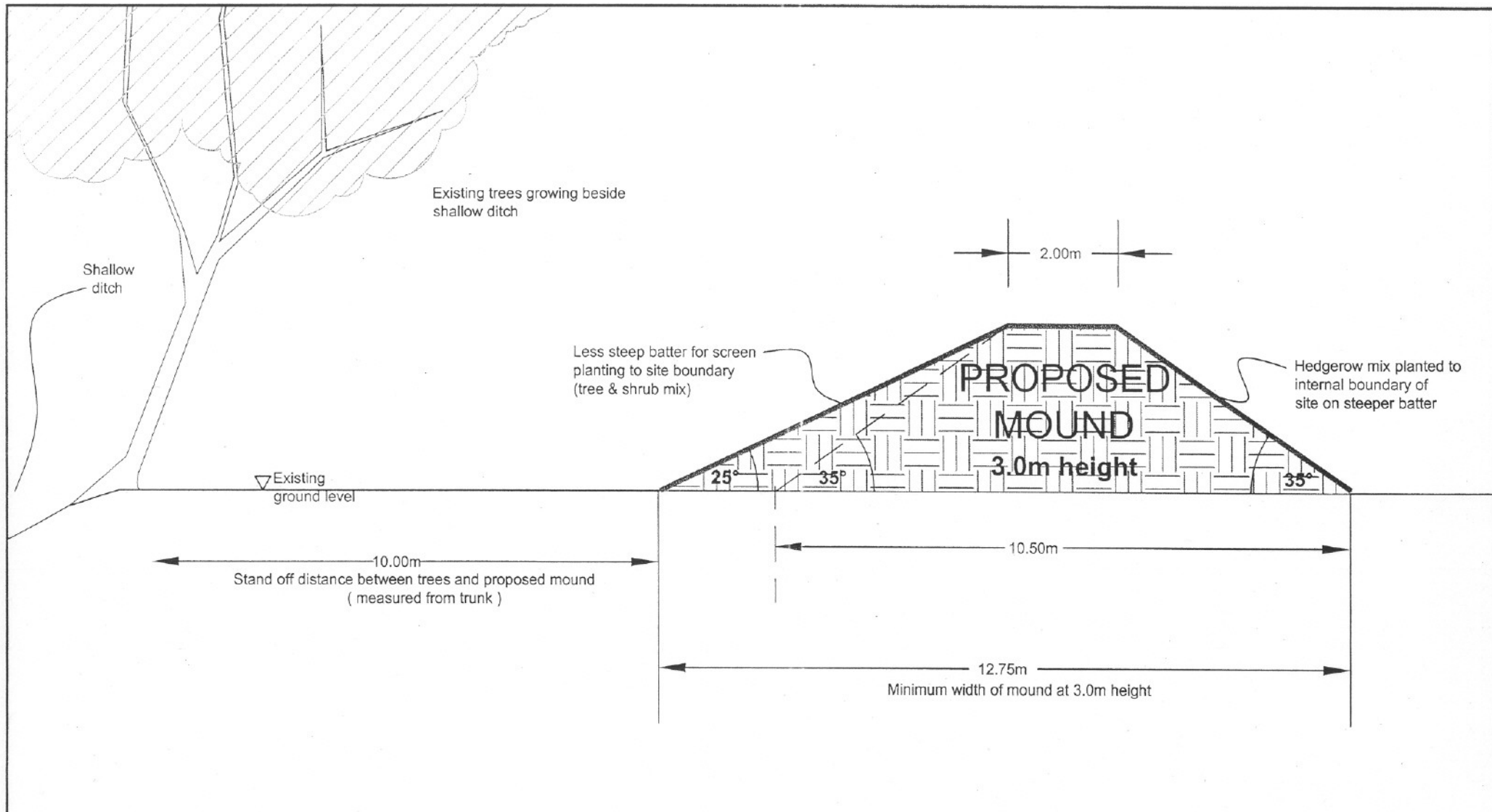

NOTES:
PLANNING COMMENTS - REF DR/DR/K50834

1. Plan submitted by applicant indicated a 45° slope - too steep for planting & too close to the existing trees
2. Site visit 25-10-94 applicant suggested 35° slope
3. Dwg above illustrates that 35° slope is still very steep for planting (normally mounds would be constructed with a 1 in 3 gradient (18°))
4. Therefore suggest 25° slope to external batter but keeping the internal batter slightly steeper. This will provide a wider buffer on the external boundary for planting trees, at a more appropriate gradient than originally proposed.



This map is based upon Ordnance Survey material with the permission of Ordnance Survey on behalf of the Controller of Her Majesty's Stationery Office © Crown copyright.

Unauthorised reproduction infringes Crown Copyright and may lead to prosecution or Civil Proceedings. Wiltshire County Council 100023-455 2004

J					
H					
G					
F					
E					
D					
C					
B					
A					
0	W/W	MMR		ORIGINAL	
REV	DATE	DRAWN	CHECK	APPR	DESCRIPTION

PROJECT:	
Monument Hill Waste Recycling Site WILTSHIRE WASTE RECYCLING LTD Proposed screen bund Application ref: DR/DR/K50834	
DRAWING TITLE:	
TYPICAL SKETCH CROSS SECTION THROUGH PROPOSED BUND showing preferred angle of slope	
SCALES:	1:100
DRAWING No:	REV: 0
FILE REF:	County Council Environmental