

<p><b>REGULATORY COMMITTEE</b></p>	<p><b>DATE</b> 13<sup>th</sup> DECEMBER 2006</p>
<p><b>PLANNING APPLICATION</b> S.06.8004</p>	<p><b>LOCATION</b> WHITEPARISH: BRICKWORTH QUARRY</p>
<p>Reproduced from the Ordnance Survey Map with the permission of The Controller of H.M. Stationery Office Crown Copyright reserved. 100023455</p>	<p><b>WILTSHIRE COUNTY COUNCIL</b>                  Director of Environmental Services                  County Hall                  Trowbridge                  Wiltshire BA14 8JD</p>
<p><b>SCALE:</b> 1:15000</p>	

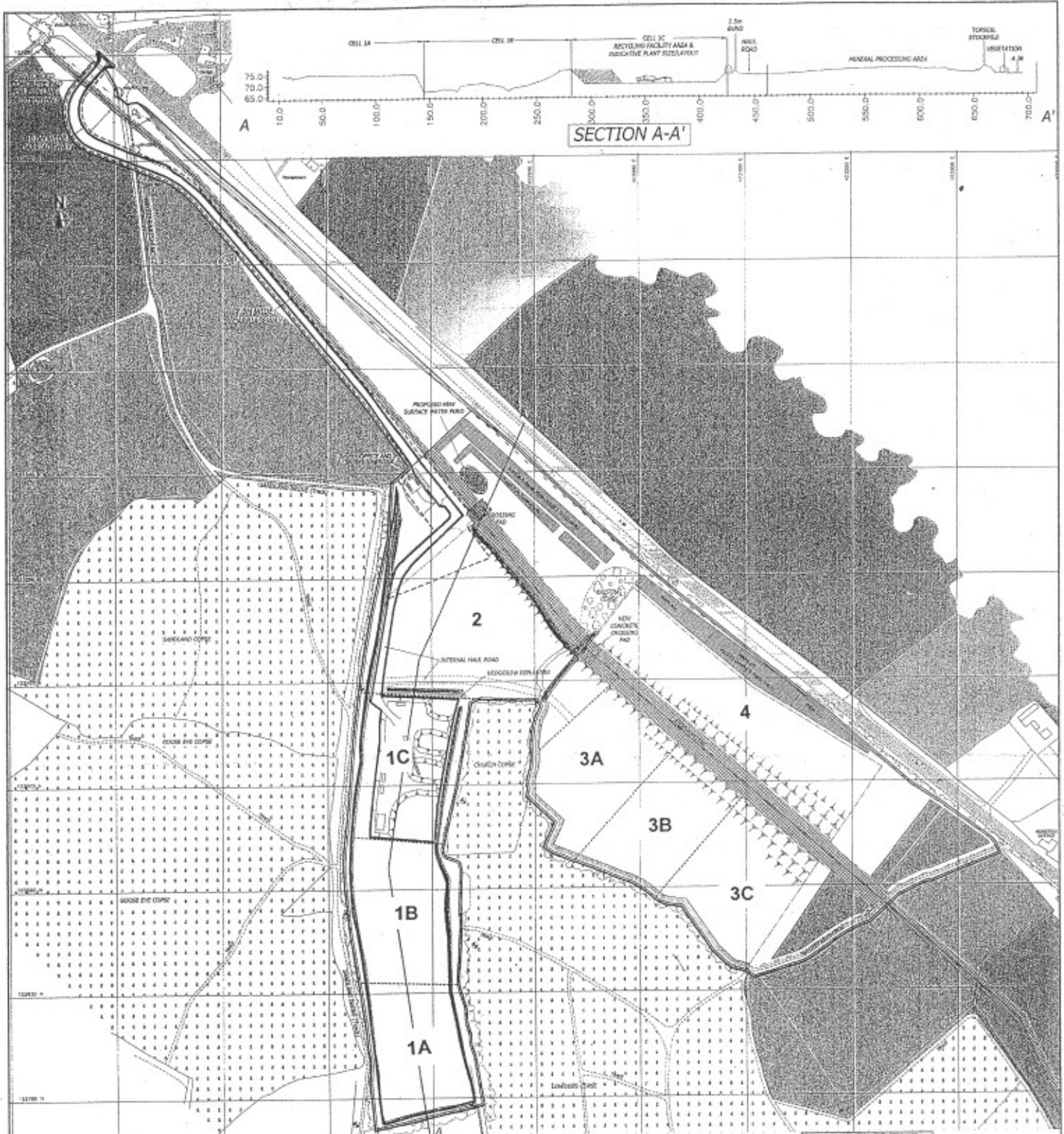

- KEY:**
- APPLICATION BOUNDARY
  - OTHER LAND WITHIN THE APPLICANT'S CONTROL
  - BOUNDARY OF PERMISSION No 5/03/0592
  - BOUNDARY OF PERMISSION No 5/01/0939
  - EXISTING PERIMETER BUNDS
  - PERIMETER BUND YET TO BE CONSTRUCTED
  - OVERBURDEN BUNDS (MAX 2m HIGH)
  - PIPELINE PROTECTIVE CORRIDOR
  - SOILS TO RESTORE PHASES 3, 4 & 1C
  - ③ PHASE NUMBER
  - PHASE BOUNDARY
  - BATTER AND BEAM TO OIL PIPE

- NOTES:**
1. THIS DRAWING IS DERIVED FROM C&C MINERAL PLANNING SERVICES DRAWING No. WJ/04/3/C (MAY 1998)
  2. PROTECTION TO THE PIPELINE TO BE IN ACCORDANCE WITH ESSO PETROLEUM COMPANY REQUIREMENTS
  3. ESSO PIPELINE ROUTE DERIVED FROM ESSO PETROLEUM COMPANY LIMITED. DRAWING No. F-4/05/01/2223. PRECISE LOCATION MUST BE VERIFIED BY E.P.C.L. PRIOR TO ANY EXCAVATION OR CONSTRUCTION WORK.
  4. SEE DRAWING NUMBER CSG/BWQ/PRP/03 REVISION A FOR DETAIL OF RECYCLING AREA

REPRODUCED FROM THE BRICKWORTH QUARRY SITE PLAN WITH THE SANCTION OF THE CHIEF OFFICER OF ENVIRONMENTAL OFFICE, NORTH YORKSHIRE DISTRICT COUNCIL LICENSE No. AL 818/04

- KEY: FOR NON SITE RELATED INDICATIVE DETAILS**
- SURROUNDINGS WOODLAND CORSE
  - SURROUNDING FIELDS AND VEGETATION
  - PERIMETER MONITORING STATION

Client: <b>CLEANSING SERVICE GROUP LTD</b>		
Project: <b>BRICKWORTH QUARRY</b>		
PROPOSED RECYCLING FACILITY LOCATION WITHIN QUARRY WORKINGS		Scale: 1:2500 @A2
Drg No: <b>CSG/BWQ/PRP/03</b>		Date: <b>NOVEMBER 2005</b>
www.rlong.co.uk		
Employers House, 14 Dinsdale Road Lynfield, Harrogate, YO21 3AE Tel: 01937 5000 0000 Fax: 01937 5000 0003 e-mail: enquiries@rlong.co.uk		
+ Waste Management + Minerals + Bar Yards + Environment		
www.rlong.co.uk		
Revision: <b>A</b>	<b>APPLICATION BOUNDARY, RECYCLING AREA</b>	
Drawn by: <b>CRM</b>	Prepared by: <b>MJ</b>	Checked by: <b>MJ</b>
		Date: <b>FEBRUARY 2006</b>

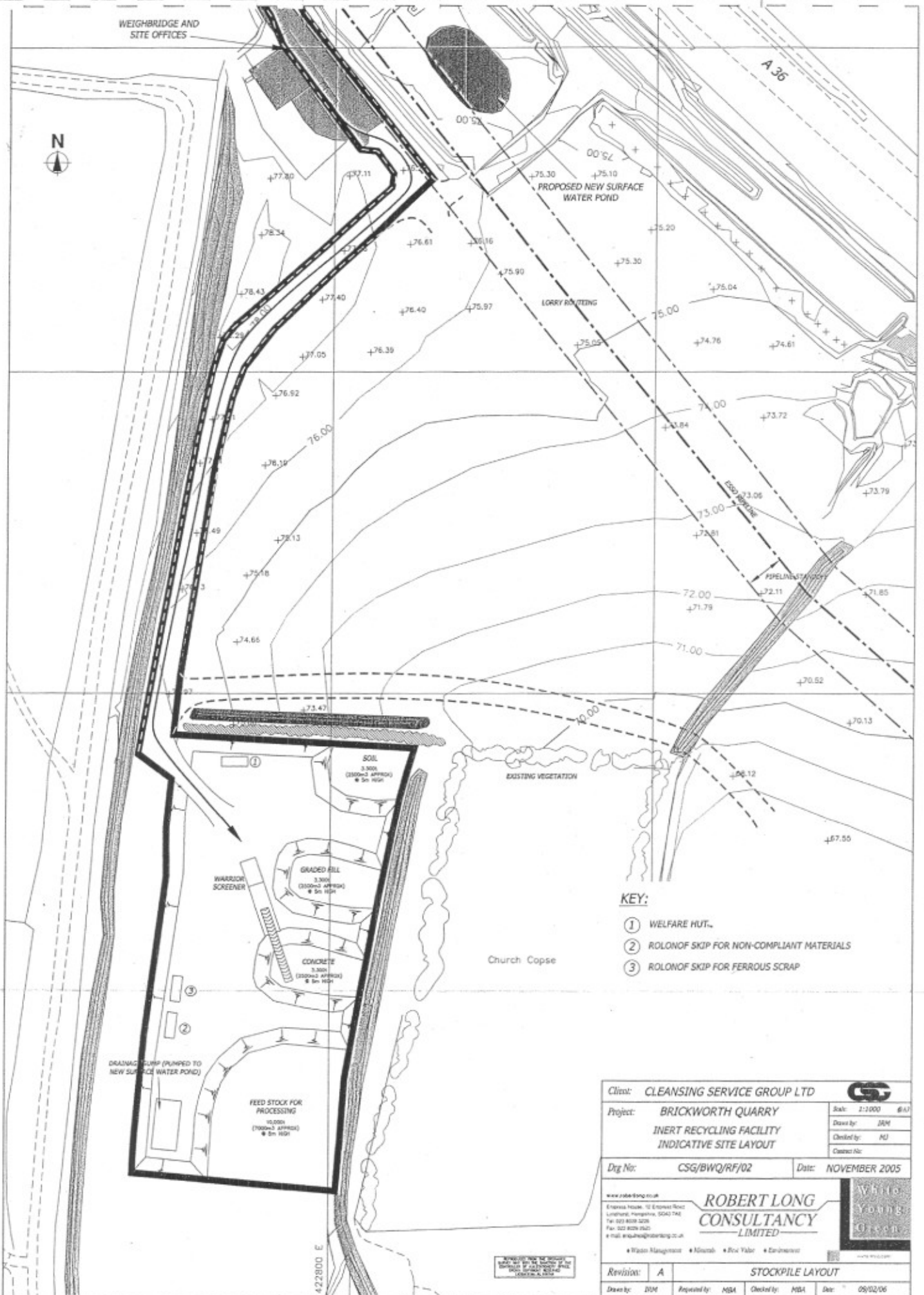

- KEY:**
- ① WELFARE HUT.
  - ② ROLONOF SKIP FOR NON-COMPLIANT MATERIALS
  - ③ ROLONOF SKIP FOR FERROUS SCRAP

Client: <b>CLEANSING SERVICE GROUP LTD</b>		 Scale: 1:1000 (A3)
Project: <b>BRICKWORTH QUARRY INERT RECYCLING FACILITY INDICATIVE SITE LAYOUT</b>		
Drawn by: <b>JRM</b>		Checked by: <b>NJ</b>
Contract No:		
Dwg No: <b>CSG/BWQ/RF/02</b>	Date: <b>NOVEMBER 2005</b>	
www.rlong.co.uk Enterprise House, 10 Enterprise Road Lutterford, Nottingham, SO43 7AE Tel: 01529 8639 5228 Fax: 01529 8639 5242 e-mail: enquiries@rlong.co.uk		
<b>ROBERT LONG CONSULTANCY LIMITED</b>		
• Waste Management • Minerals • Bulk Yards • Environment		
Revision: <b>A</b>		<b>STOCKPILE LAYOUT</b>
Drawn by: <b>JRM</b>	Requested by: <b>NBA</b>	Checked by: <b>NBA</b> Date: <b>09/02/06</b>

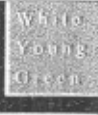

NOT TO SCALE  
 THIS PLAN IS A SUMMARY OF THE  
 OFFICIAL SURVEY RECORD  
 DRAWING A 36