

# Section

*of the*

PROPOSED

Salisbury, Romsey  
AND

AND

Southampton

RAILWAY

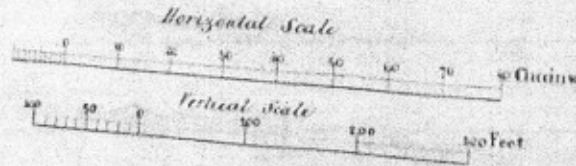

*Jacob Swynne*  
*Civil Engineer*

*Nov 30th 1836.*



Plan of the **WAPPING**

**SALTSBURY**

**Ramsay & Southampton**

**RAILWAY.**

Scale 4 Inches to 1 Mile.



The Railway, Part, is drawn to 5 Chains to 1 Inch.

Jas H. Raymond  
Civil Engineer

Nov 30th 1836.

November 30<sup>th</sup> 1836

This Plan was deposited in  
my Office. In Witness Whereof  
I have hereunto set my Hand and  
Seal of the Office of the  
Surveyor of the Lands of the  
City of New York.

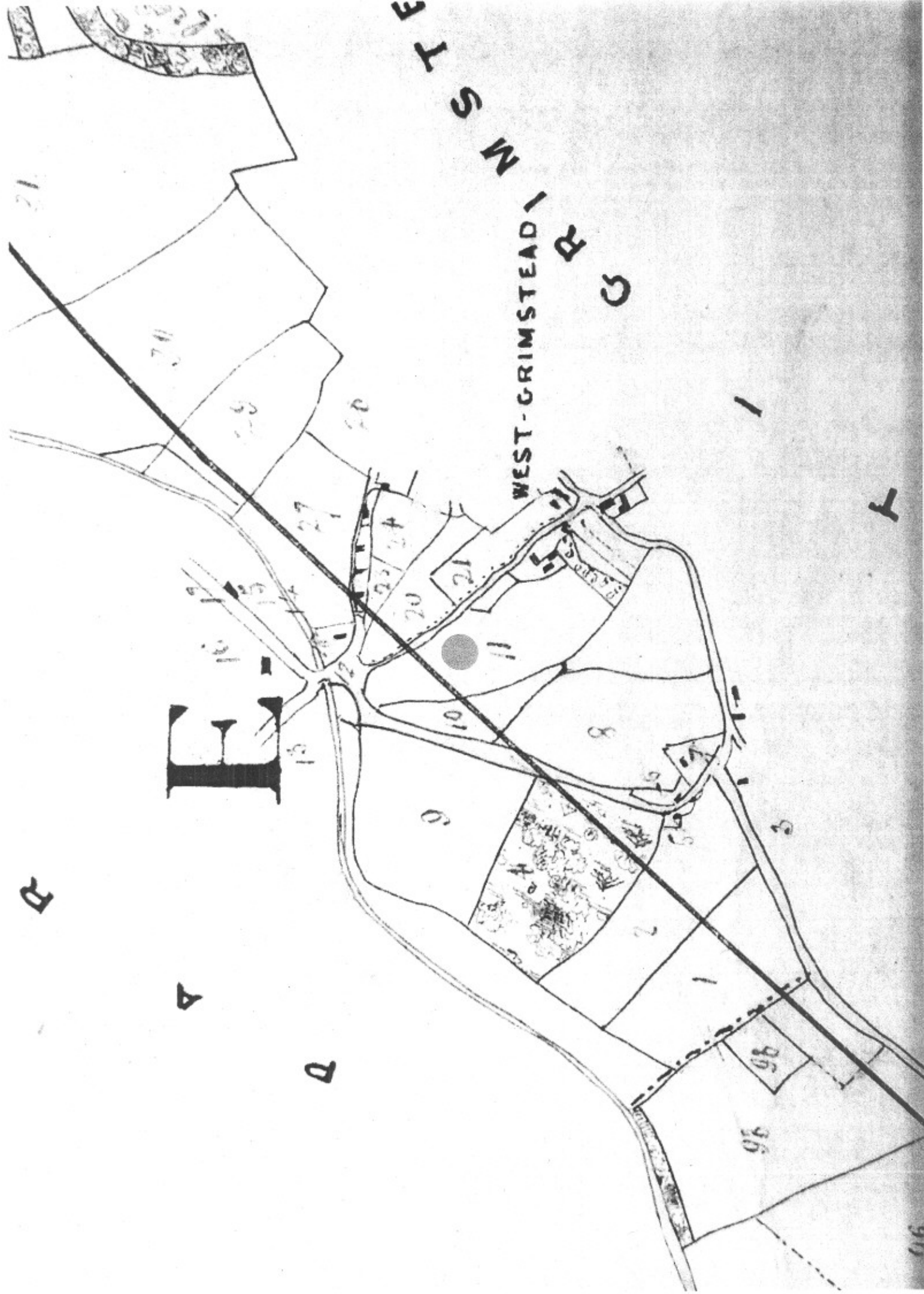

**COMPANIES SALISBURY, ROMSEY, AND SOUTHAMPTON RAILWAY COMPANY.**

BOOK of REFERENCE to the Map or Plan of the said intended Railway, containing a list of the Owners, or reputed Owners, Lessees, or reputed Lessees, and Occupiers of the Lands and Premises in which the Railway is intended to be made.

Premises in the Parish of *Witchampton* of *Westbury* in the County of *Wiltshire*

| Property. | Owners or reputed Owners. | Lessees or reputed Lessees. | Over.                 |
|-----------|---------------------------|-----------------------------|-----------------------|
|           | <i>Phillip Cornish</i>    |                             | <i>Thomas</i>         |
|           | <i>Carl of Radnor</i>     |                             | <i>John West</i>      |
|           | <i>Rev. J. C. Hoare</i>   |                             | <i>John Reed</i>      |
|           | <i>Carl of Radnor</i>     | <i>James Nichols</i>        | <i>Carl of Radnor</i> |
|           | <i>Carl of Radnor</i>     | <i>James Hoare</i>          | <i>James Hoare</i>    |
|           | <i>Carl of Radnor</i>     | <i>James Hoare</i>          | <i>James Hoare</i>    |
|           | <i>Carl of Radnor</i>     | <i>William Hoare</i>        | <i>William Hoare</i>  |
|           | <i>Carl of Radnor</i>     | <i>James Hoare</i>          | <i>James Hoare</i>    |
|           | <i>Carl of Radnor</i>     | <i>Charles Hoare</i>        | <i>Charles Hoare</i>  |
|           | <i>Carl of Radnor</i>     | <i>James Hoare</i>          | <i>James Hoare</i>    |

