

## **Design Team A summary of submission**

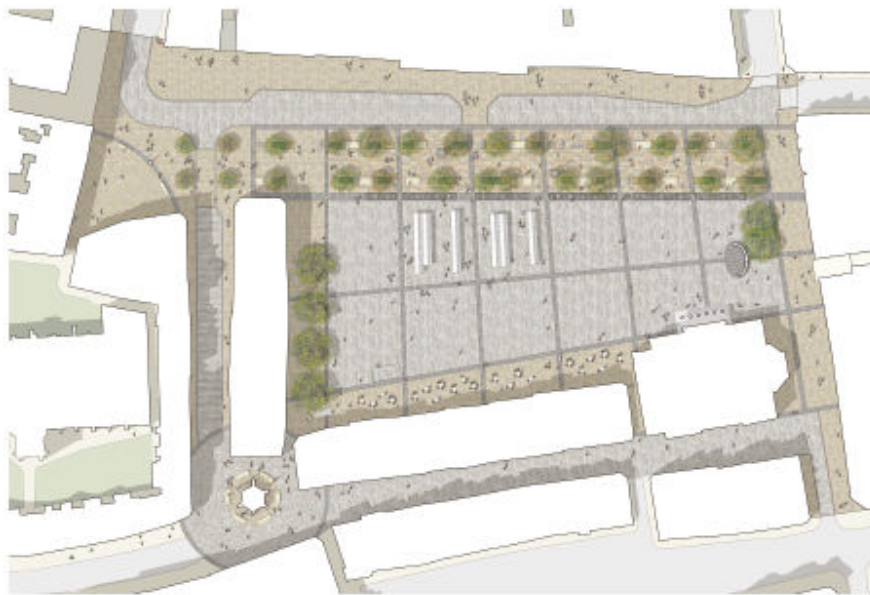

- A large flexible open central space for all kinds of existing and new events and outdoor entertainments
- A high quality natural stone surface with electric points and a refuse store hidden below ground
- A high quality setting to attract new visitors into the city and to give a boost to local businesses
- A new dramatic and flexible lighting scheme
- Deliveries as usual to businesses and retailers in and around the Market Place
- An improved setting for the war memorial



- More room for the Charter Market to thrive and expand
- More space to ease movement around the annual Charter Fair; to improve safety and reduce the number of vehicles



- A beautiful linear fountain at the bottom of the Market Place, which is safe and practical for children to walk through and play in
- Plenty of new seating under the colonnade of trees on Blue Boar Row